

BoneHearing F2

Bone Conduction
Sound Amplifier Headpones

User Manual

WHAT'S IN THE BOX

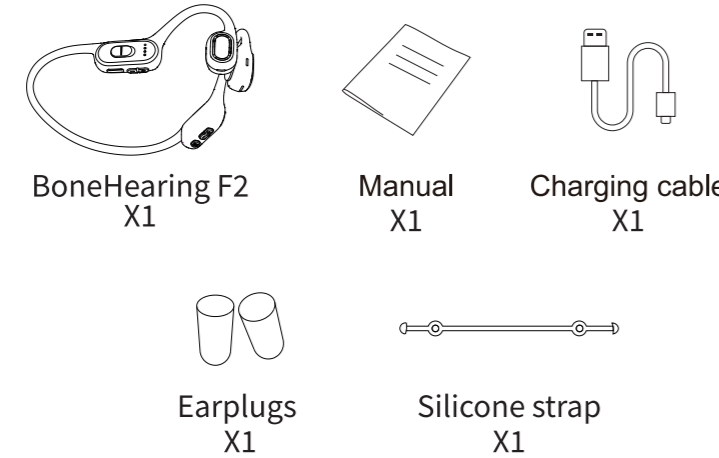

HOW TO WEAR



- Place the headphones over your ears, ensuring the ear hooks fit snugly without blocking the ear canal.
- Adjust the conduction units to rest on your cheekbones for optimal sound.

BUTTON CONTROL

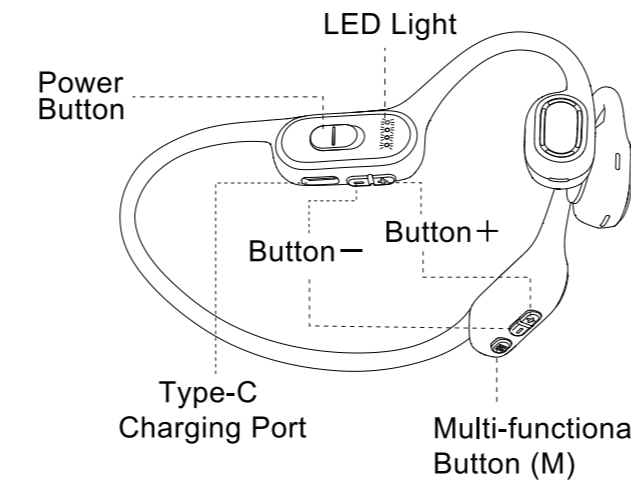

SILICONE STRAP USAGE

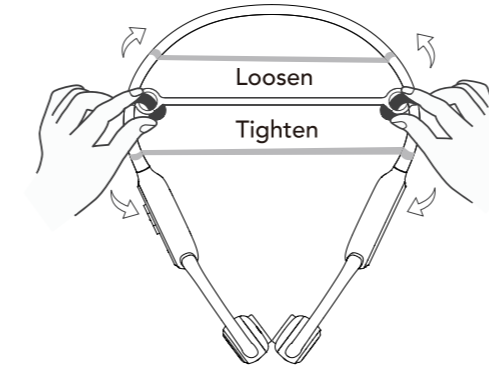

For a smaller head circumference, use this silicone strap accessory to secure headphones better. Tie each end of the strap to the headphone band behind the ears.

POWER ON/OFF

POWER ON

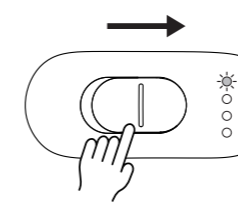

- The 1st LED flashes in white for 3 times. Prompt: power on pairing.

POWER OFF

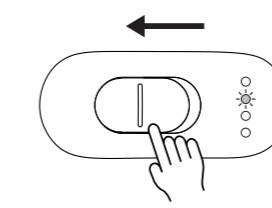

- The 2nd LED flashes in white for 3 times. Prompt: Power off.

BATTERY LEVEL NOTIFICATION

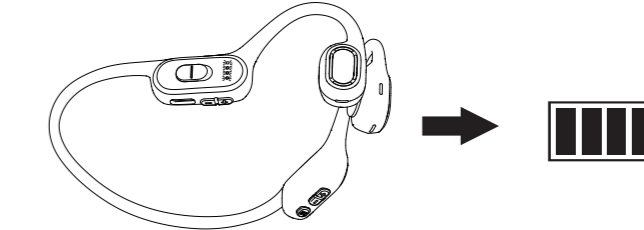

Automatically announce the real-time battery level of the headphones after power on.
Battery 100%-70%: battery high.
Battery 69%-40%: battery medium.
Battery 39%-10%: battery low.

THREE AMPLIFIER MODES

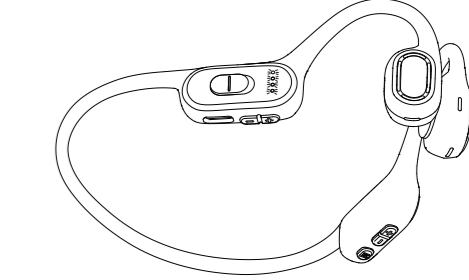

The headphones is built-in 3 different sound modes for amplifying.
Click button M to switch indoor mode / outdoor mode / vocal mode.

VOLUME CONTROL

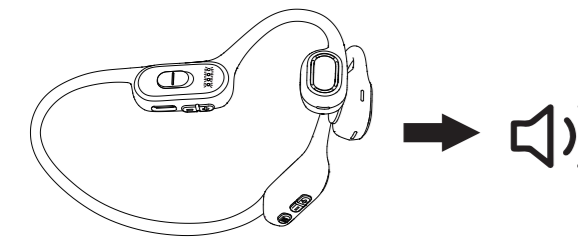

F2 supports independent volume adjustment for the left and right ears.

Press the +/- button on the left/right earbud to adjust the volume. When the maximum volume is reached, Prompt: Maximum volume.

WIRELESS MODE

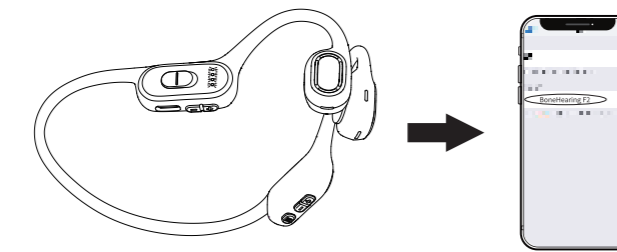

Switch Amplifier / BT Mode

Double click the button M. Prompt: Wireless mode / Amplifier mode.

BT Connection

Select "BoneHearing F2" in BT menu to connect. Prompt: connected.

MUSIC CONTROL

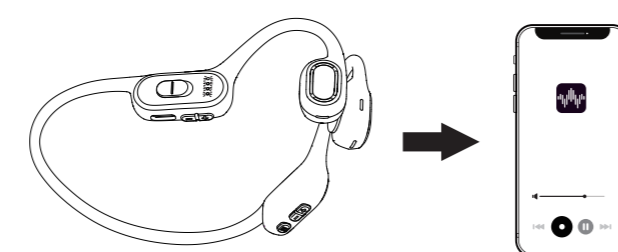

- Volume Up: Click the button + .
- Volume Down: Click the button - .
- Previous Track: Long-press the "+" button on either side.
- Next Track: Long-press the "-" button on either side.
- Play/Pause Music: Click the button M once.

CALL CONTROL

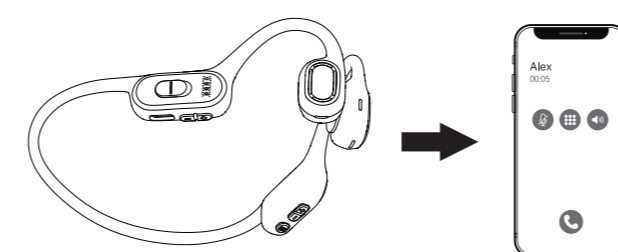

- Answer/Hang Up A Call: Click the button M once.
- Reject A Call: Double click the button M.
- Activate Voice Command: Quickly triple-click the button M.

LOW BATTERY

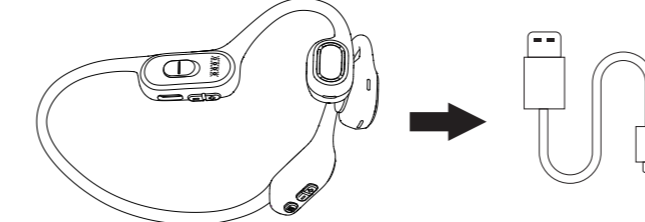

Low Battery

- When battery is lower than 20%, prompt: battery low.

Charging

- Please use DC 5V adapter for charging. Green LED is on after fully charged.

CHARGING LED INDICATORS

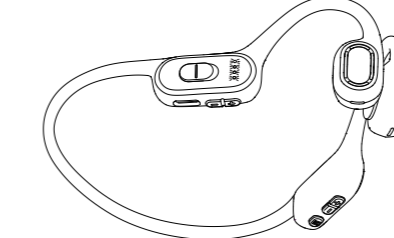

- ● ● ● Battery 75-100%
- ● ● ○ Battery 50-75%
- ● ○ ○ Battery 25-50%
- ○ ○ ○ Battery 15-25%
- ☀ ○ ○ ○ LED blinks, please charge.

SPECIFICATIONS

Model	BoneHearing F2
Type	Bone conduction sound amplifier headphones
BT Version	V5.3
Connection	≈15m
Continuous wireless usage time	≥6h(80%volume)
Continuous amplifying usage time	≥6h(80%volume)
Charging Time	≈1h
Charging Voltage	DC 5V
Waterproof Rating	IPX5

ATTENTIONS

- High-volume use can damage your hearing. Follow safe volume and time limits and get regular hearing check-ups.
- Headphones affect your awareness of surroundings, please use them with caution.
- Do not disassemble or modify the headphones.
- Avoid throwing, sitting on, or burning the headphones.
- Keep headphones away from fire and high-voltage equipment.
- Not for children under ten due to small parts.
- Recycle headphones at an electronics facility, not as regular waste.
- Consult a doctor if you have serious hearing issues before using bone conduction headphones.

Note: The company is not liable for damage resulting from non-compliance with these warnings.